

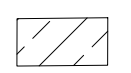
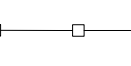
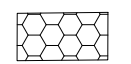

**LEGEND**

-  SNOW STORAGE
-  SILT FENCE
-  MUD MAT
-  OVERLAND FLOW ARROW

**MUD MAT NOTES**

1. INSPECT THE ENTRANCE DAILY. REMOVE ALL SEDIMENT DEPOSITED ON THE PUBLIC ROADWAY AND RETURN TO THE CONSTRUCTION SITE. ENSURE ANY SEDIMENT LADEN WATER FROM THE MUD AT OR STREET CLEANING IS COLLECTED AND TREATED.
2. MAINTAIN THE SPECIFIED MUD MAT THICKNESS. PLACE ADDITIONAL ROCK WHENEVER ROCK BECOMES CLOGGED WITH SEDIMENT.
3. MAINTAIN STOCKPILE OF 50mm CLEAR RUN LIMESTONE
4. CONSTRUCT A MOUNTABLE BERM ONLY WHEN 150mm MIN COVER CANNOT BE PROVIDED OVER THE PIPE.

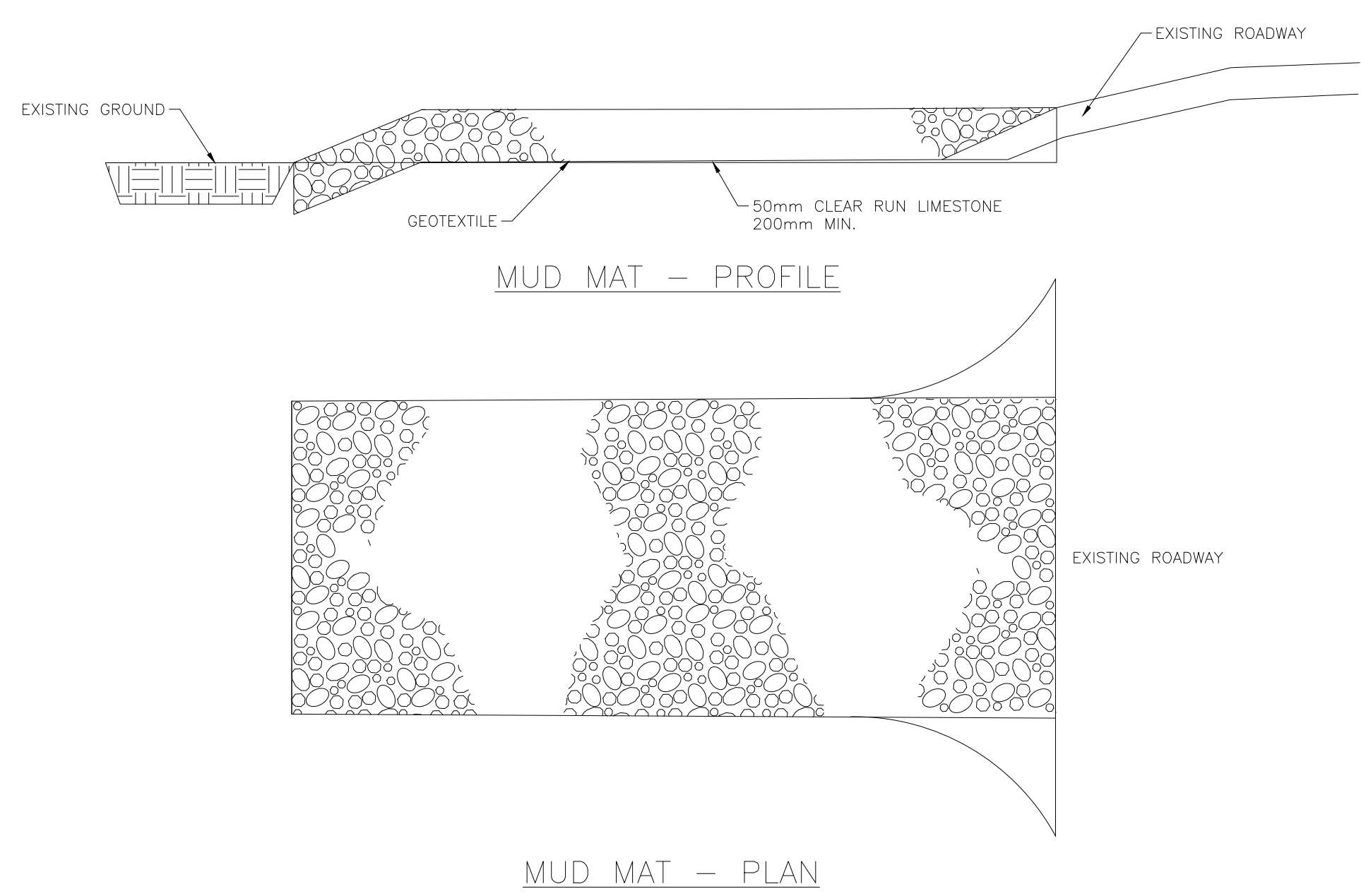

**NOTES**

1. EXACT LOCATIONS OF SILT FENCES ARE TO BE DETERMINED ON SITE BY THE CONTRACTOR IN CONSULTATION WITH THE ENGINEER AND OWNER.
2. ALL CONSTRUCTION VEHICLES TO ENTER AND LEAVE THE SITE AT APPROVED LOCATION ONLY.
3. THE CONTRACTOR SHALL BE RESPONSIBLE FOR THE PROPER INSTALLATION, MAINTENANCE, AND REMOVAL OF ALL TEMPORARY EROSION AND SEDIMENT CONTROL MEASURES DURING CONSTRUCTION, AS DIRECTED BY THE ENGINEER
4. ADDITIONAL EROSION AND SEDIMENT CONTROL MEASURES MAY BE REQUIRED AND SHALL BE DETERMINED BY THE ENGINEER.
5. SILT CONTROL FENCING SHALL BE INSTALLED ACCORDING TO THE DRAWING AND MAINTAINED DURING ALL CONSTRUCTION PHASES OF THE PROJECT.
6. NO CONSTRUCTION ACTIVITY OR MACHINERY SHALL INTRUDE BEYOND THE SILT/SNOW FENCE OR LIMIT OF DEVELOPMENT. ALL CONSTRUCTION VEHICLES SHALL LEAVE THE SITE AT DESIGNATED LOCATIONS AS SHOWN ON THE PLANS. ALL MATERIAL AND EQUIPMENT SHALL BE STORED ON SITE IN A DESIGNATED AREA. NO MATERIAL OR EQUIPMENT SHALL BE STORED ON THE MUNICIPAL RIGHT OF WAY. NO CONSTRUCTION VEHICLES WILL PARK ON THE MUNICIPAL ROADS.
7. ALL EXPOSED SOILS SHALL BE IMMEDIATELY STABILIZED WITH A SEED AND MULCH APPLICATION AS DIRECTED BY THE ENGINEER.
8. STOCKPILES SHALL BE SET BACK FROM ANY WATERCOURSE AND STABILIZED AGAINST EROSION AS SOON AS POSSIBLE. A SETBACK OF AT LEAST 15m FROM ANY TOP OF BANK OR WATERCOURSE IS REQUIRED.
9. CLEANING AND REPAIRS OF CHECK DAMS, MUD MATS, AND ANY OTHER TEMPORARY SEDIMENT CONTROL MEASURES SHALL BE DONE AS NECESSARY THROUGH REGULAR INSPECTION OR AS DIRECTED BY THE ENGINEER.
10. ALL RE-GRADED AREAS WITHIN THE SITE WHICH ARE NOT OCCUPIED BY ROADWAYS OR DRIVEWAYS SHALL BE TOP SOILED AND SODDED/SEEDED IMMEDIATELY AFTER COMPLETION OF FINAL GRADING OPERATIONS OR AS DIRECTED BY THE ENGINEER.
11. INSPECTION OF THE PROPOSED EROSION AND SEDIMENT CONTROL MEASURES WILL OCCUR ON A WEEKLY BASIS, AFTER SIGNIFICANT RAINFALL OR SNOW MELT EVENTS, AND DAILY DURING EXTENDED RAIN OR SNOW MELT PERIODS.
12. MATERIALS TO REPAIR DAMAGED ESC MEASURES MUST BE KEPT ON SITE AT ALL TIMES
13. THE ESC STRATEGIES ON THESE PLANS ARE NOT STATIC AND MAY NEED TO BE UPGRADED/AMENDED AS SITE CONDITIONS CHANGE TO PREVENT SEDIMENT RELEASE TO THE NATURAL ENVIRONMENT. FAILED ESC MEASURES MUST BE REPAIRED IMMEDIATELY.
14. SERVICING OF CONSTRUCTION EQUIPMENT ON SITE IS PROHIBITED.
15. CLEANING OF EXISTING ROAD AT SITE ACCESS POINTS SHALL BE DONE DAILY DURING CONSTRUCTION OR AS NECESSARY THROUGH REGULAR INSPECTION OR AS DIRECTED BY THE ENGINEER.
16. ALL DAMAGED ESC MEASURES SHOULD BE REPAIRED AND/OR REPLACED WITHIN 48 HOURS OF THE INSPECTION. IF EXCESSIVE SILTATION RESULTS FROM THE CONSTRUCTION ACTIVITIES, THE ONSITE SUPERVISOR OR INSPECTOR RESERVE THE RIGHT TO REQUEST ADDITIONAL SILTATION CONTROL MEASURES WHICH WOULD BE INSTALLED PRIOR TO FURTHER CONSTRUCTION ACTIVITIES

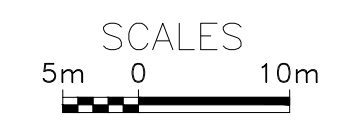
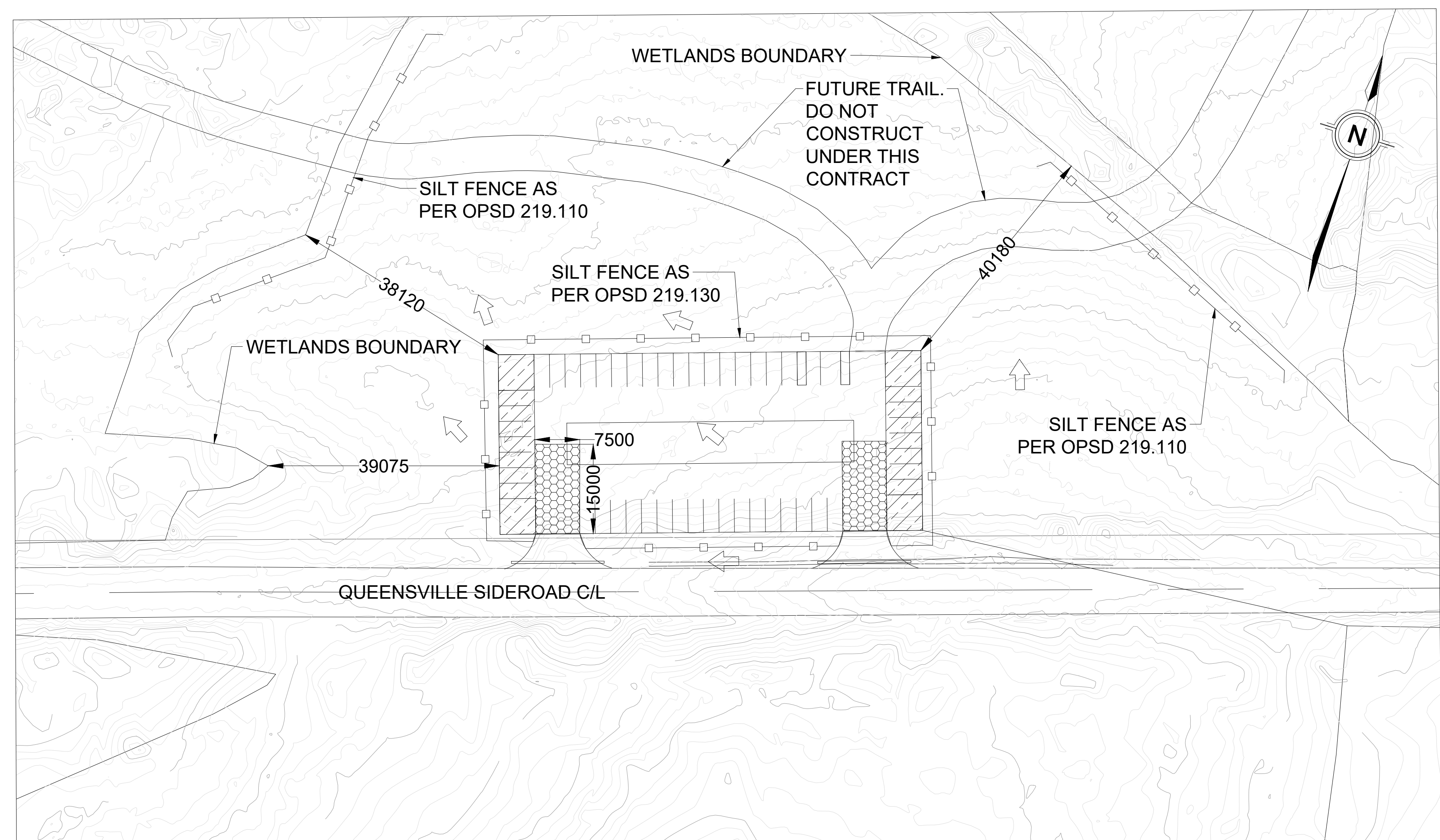

No.	DATE	REVISIONS	BY
1	03/17/23	ISSUED FOR 30% REVIEW	NT



DESIGN NT	QUEENSVILLE SIDEROAD YORK REGION FOREST EROSION AND SEDIMENT CONTROL PLAN	DWG. NO. 1301
DRAWN NT		CONT. NO.
CHECKED MP		SHEET NO.